



**Load capacity:** 15 kN test load EN 124

**Material:** Frame made of aluminium extruded sections. Cover made of 3/4,5 mm aluminium chequerplate. Aluminium reinforcement on the underside. Stainless steel screws. Good chemical resistant seal

**Features: RVA-RA Alu in largely sealed design (construction similar to RVA):** New modular design with enormous advantages. The frames are connected with cross-beams elements in the longitudinal direction. For larger covers (from a length of approx. 3 m) the HAGODECK multi access cover is delivered disassembled and again assembled on site. **Patent cross-beam system:** The system of intermediate webs (cross beam) is registered with patent. The cross-beams are simply inserted and fixed. They can be easily removed again without effort when the the shaft must be freely accessible along its entire length, e.g. for the subsequent installation of pipelines or for pipelines or for repair work in the manhole.

**The Lift-Off opening system:** Every HAGODECK Type RVA-RA alu cover comes with a set of lifting keys and precise installation instructions.

**Odor and waterproof:** HAGODECK Type RVA-RA convinces by its low weight. Carefully sealed with EPDM seals. Complete water tightness not guaranteed!

**Applications:** Due to the low weight and high corrosion resistance, the RVA-RA is the ideal cover for supply and disposal channels.

**Installation:** Installation must be carried out according to our instructions. With water-tight models, care must be taken to seal the outer frame into the surrounding flooring.

**Specification clause:** [www.hago.at](http://www.hago.at)



RVA-RA



removed cover

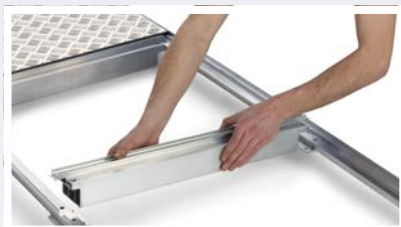

removable cross-beam

RVA-RA Alu

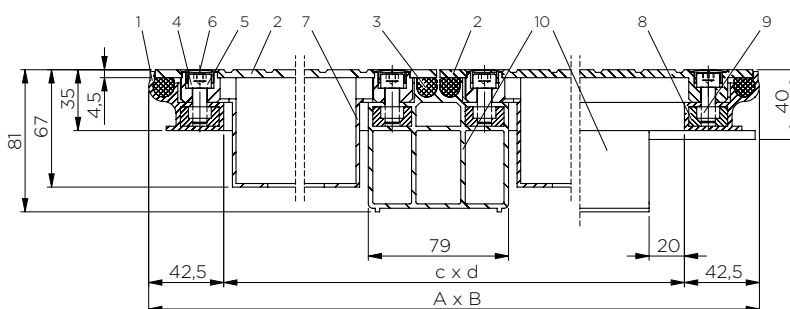

- |               |                           |               |
|---------------|---------------------------|---------------|
| 1 Frame       | 5 sleeve                  | 8 plastic cap |
| 2 Cover       | 6 plastic cap             | 9 square nut  |
| 3 Seal        | 7 reinforced chequerplate | 10 cross-beam |
| 4 Allen screw |                           |               |